

LICENZA

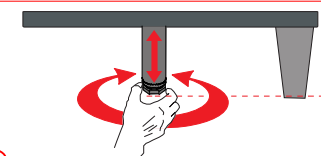
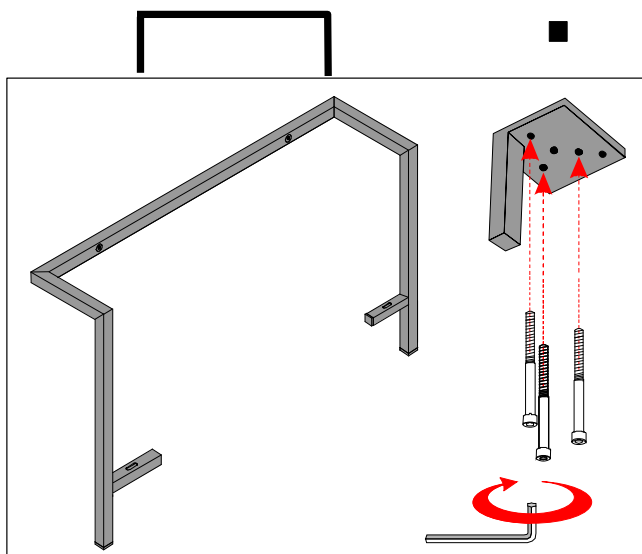
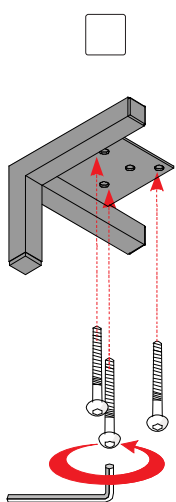
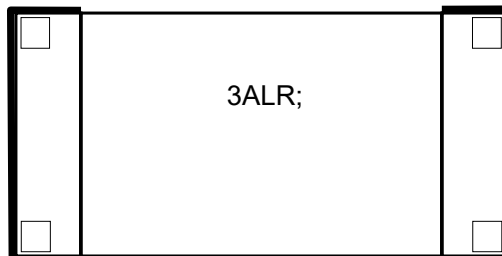
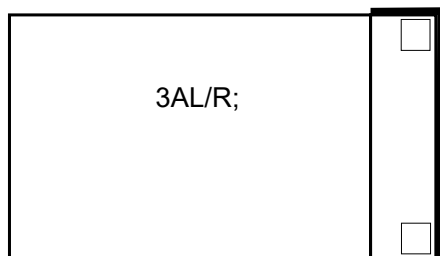
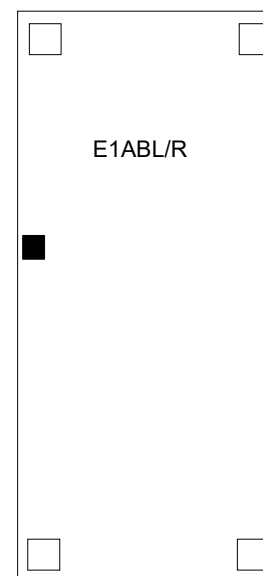
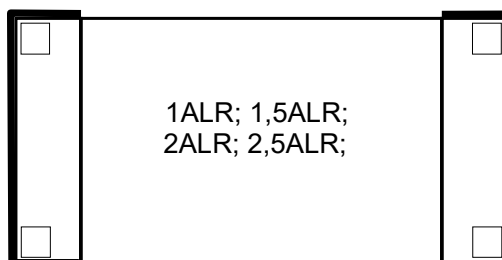
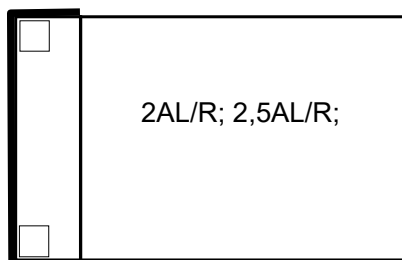
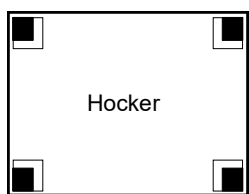

NL
Nadat u het meubel thuis heeft geplaatst,
kunt u de hoogte van de verstelbare steunpoten
instellen door te draaien aan het onderste gedeelte
van de poot.

D
Nachdem Sie die Möbel zu Hause hingestellt haben,
regulieren Sie bitte die Fusshöhe,
indem sie den unteren Fussteil entweder
auf- oder zudrehen.